

# EcoSep™

## Internally-Fed Rotary Drum Screen

The EcoSep™ is a rotary screen for liquid/solid separation consisting of a SUS 304 cylindrical “V” shape wedge wire screen or drilled hole screen with inner solid discharge blades arranged in a helicoids pattern. The screen cylinder features a drive and a discharge end and is driven by a gear motor, chain, and sprockets, while supported by turn-on wheels mounted on a base frame. A dual-discharge weir internally feeds the screen. Splash guards and top cover enclose the screen while liquid is discharged through the base.



### Operation

EcoSep Drum Screens consist of a perforated drum with internally fixed screw, which transports the separated particles out of the drum. The drum rotates on trunnion wheels and is driven by a gear motor. Incoming liquid is fed into the drum through an inlet pipe, which distributes the water over a large area of the drum’s interior. During passage through the drum, the liquid is screened through the drum’s perforations and collects in the trough underneath. Separated particles are transported out of the drum through the screenings outlet. Dewatering continues throughout transport in the drum. To prevent clogging of the unit’s perforations, all drum screens are fitted with a spray header with spray nozzles.

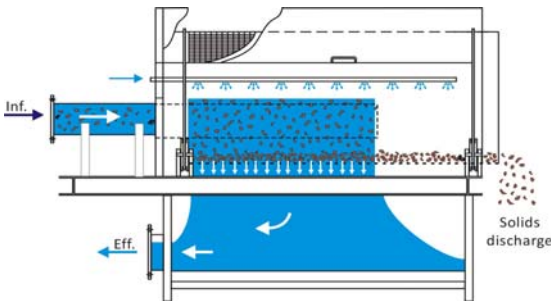

### EcoSep offering the following benefits:

- Triangular (V-shaped) wedge wire screen design
- Double spray bar design
- Wide range of industrial applications
- Low capital and operation cost
- Provides long years of reliable, trouble free service
- Automatic operation, requires little operator attention

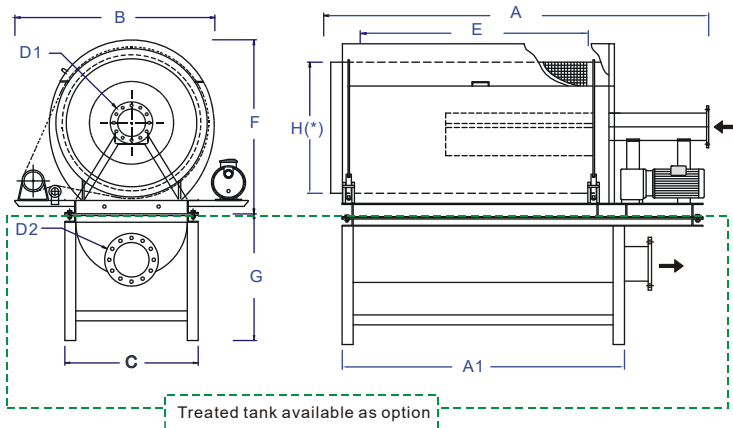

### Applications

- Slaughterhouses, Meat-packing industry
- Poultry, Fisheries, Dairy industry
- Rendering, Gelatin manufacturing
- Sugar mills, Citrus fruit processing
- Canneries, Wineries, Breweries, Beverages
- Paper mills, Textile mills, Mining
- Municipal wastewater pre-treatment

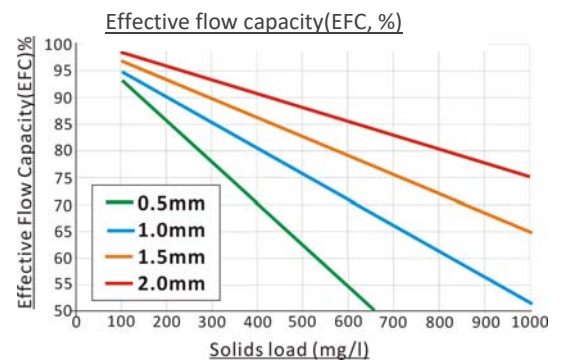

### EcoSep™ Dimensions and Technical Data

Model	Screen opening(mm)				Dimensions(cm)									Motor(Hp)	
	0.5	1.0	1.5	2.0	A/A1	B	C	D1	D2	E	F	G	Drum motor	Jet pump	
	Flow rate,m <sup>3</sup> /h(*)														
RF-0608-WG	60	70	80	95	154/119	99	69	6"	8"	80	85	60	1	1	
RF-0612-WG	75	105	120	165	194/159	99	69	6"	8"	120	85	60	1	2	
RF-0908-WG	140	170	190	195	154/119	137	91	8"	10"	80	114	80	1	1	
RF-0910-WG	175	200	225	250	174/139	137	91	8"	10"	100	114	80	2	1	
RF-0912-WG	220	260	290	300	194/159	137	91	8"	10"	120	114	80	2	2	
RF-0920-WG	350	410	420	420	274/239	137	91	10"	12"	200	114	80	2	2	

■ H(\*): Screen Drum Diameter: RF-06: 600mm, RF-09: 900mm

(\*)Based on clean water

■ Screen and construction: SUS 304, 316 available as option

■ Dimensions subject to change without notices